

- NOTES:
- INPUT SHAFT MOMENT OF INERTIA (WR²) = 15.61 LB-FT²
 - RECOMMENDED GEAR OIL:
BELOW -10°F USE 75W
BETWEEN -10°F AND 100°F USE 80W90
ABOVE 100°F USE 85W140
 - MAX ALLOWABLE OPERATING TEMPERATURE IS 220°F (104°C)
 - CHANGE OIL & FILTER (P/N 600-10190-1) AFTER FIRST 100 HOURS OF SERVICE AND EVERY 6 MONTHS THEREAFTER
 - ASSEMBLY PAINTED BLACK POLYURETHANE, SPEC AUE-300/301

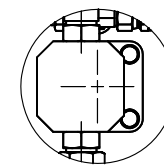

NOTE OIL PUMP OFFSET!!
THIS OFFSET IS NECESSARY FOR OIL PUMP OPERATION
WHEN INPUT SHAFT ROTATES CW!!